

SHUT-OFF BLADES

Characteristics

- ▶ Shut-off blades for under pressure tapping saddles and connectors.

SHUT-OFF BLADES FOR THREADED and PE32&50 OUTLET SADDLES

- ▶ Shut-off blades for **OPTIMQ** thread saddles of $\frac{3}{4}$ ", 1", $1\frac{1}{2}$ " and 2" and PE outlet saddles sizes PE32 and PE50
- ▶ It can be moved by hand or with a $\frac{3}{4}$ " wrench or a $\frac{1}{2}$ " ratchet wrench.

SHUT-OFF BLADES FOR FLANGED and PE90&110 OUTLET SADDLES

- ▶ The DN65/80 and DN100 shut-off blades are assembled on the same arm
- ▶ By coupling the 24-mm wrench to the arm butt the shut-off blade can be removed under pressures of more than 10bar.
- ▶ Quick blade-change system.

MATERIALS

- ▶ Nickel-plated steel arm.
- ▶ Heat treated stainless steel blade.
- ▶ Treated nickel-plated steel screws.

Advantages

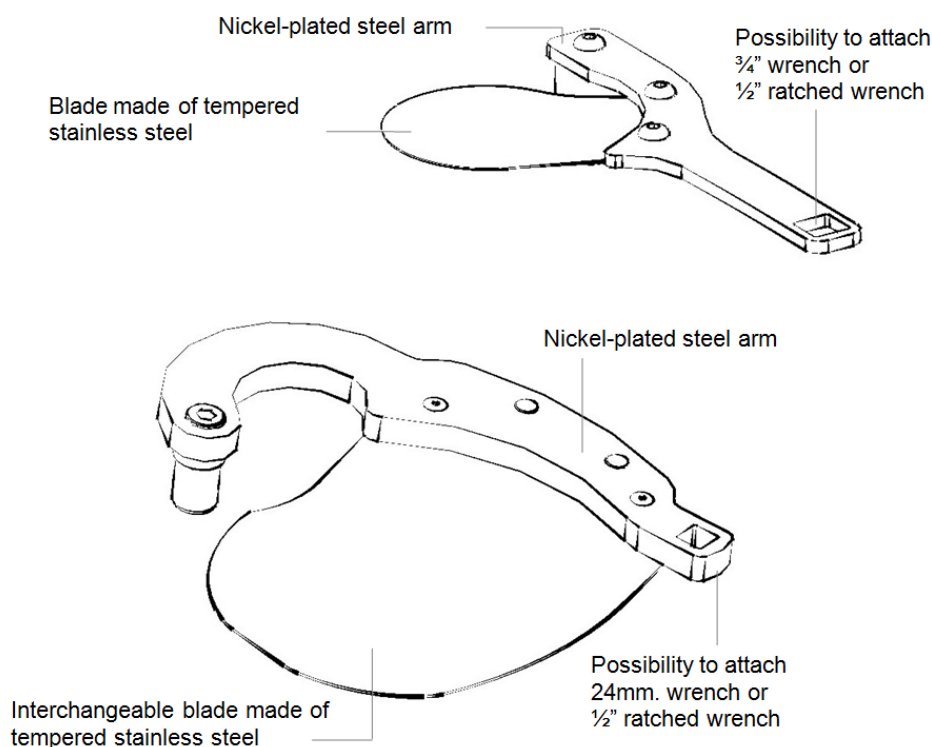

NEW



SHUT-OFF BLADES

SHUT-OFF BLADE FOR THREADED AND PE32&PE50 OUTLET SADDLES

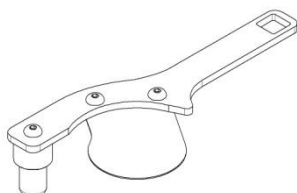

1" Shut-off blade

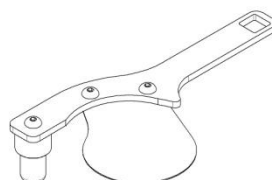

2" Shut-off blade

SHUT-OFF BLADE FOR DN65, DN80, DN100 FLANGED AND PE90&PE110 OUTLET SADDLES AND CONNECTORS

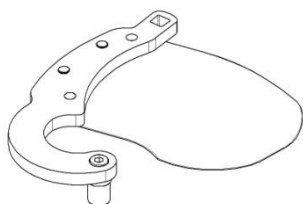

Shut-off blade

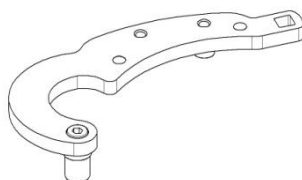

Arm blade

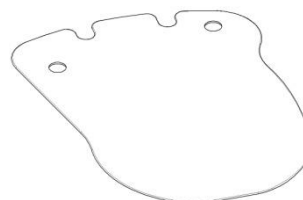

Blade

Codes, names and dimensions

SHUT-OFF BLADES			
Code	Name	Dimensions mm	Weight kg
OQ80840	1" Shut-off blade (for ¾", 1" & PE32)	175 x 80 x 40	0,190
OQ80850	2" Shut-off blade (for 1¼", 1½", 2" & PE50)	175 x 100 x 40	0,200
OQ80811	65/80 Shut-off blade	250 x 220 x 60	1,340
OQ80812	100 Shut-off blade	250 x 200 x 60	1,380
OQ80810	Arm blade	250 x 120 x 60	1,160
OQ80820	65/80 Blade	200 x 150 x 1	0,180
OQ80830	100 Blade	220 x 150 x 1	0,220